

MEETINGS MADE EASY

VIENNA

FEEL THE DIFFERENCE
radissonblu.com/meetings

WELCOME

Are you a fan of the finer things in life, and of understatement too? The great outdoors and fresh air are as important to you as art and culture? The Radisson Blu Park Royal Palace Hotel has it all. Take time out from your sightseeing or business schedule for a relaxing stroll through the grounds of nearby Schönbrunn Palace, or draw inspiration from the spirit of innovation and exhibits to be found at the Museum of Technology right next door to the hotel. The historic city centre, where art, culture and world-class shopping await, is easily reached thanks to the nearby underground station.

MEETING ROOMS

A stimulating environment that still has plenty of space for new ideas: host your meeting, conference or event in one of our 9 fully equipped seminar rooms. Ideal layouts and flexible partitioning mean that nothing stands in the way of your event's success – whatever form it takes. A ballroom (total size 606 m² - three rooms) with a total capacity of 500 people, along with the other modern seminar rooms, will make your conference an unforgettable event.

ROOMS & SUITES

Choose from 176 Superior Guest Rooms, 36 Business Class Rooms, 14 One Bedroom Suites and 7 One Bedroom Executive Suites. Our exclusive rooms are a true delight: noble Zebrano timber contrasts with sand-coloured elements, creating a beautiful visual effect in natural and indirect lighting. They also include fantastic views over Schönbrunn Palace or the hotel park. Additionally, all rooms feature top-class amenities, including high-speed internet, flat-screen televisions and much more.

A true highlight of Radisson Blu Park Royal Palace Hotel is Suite no. 455 – the “Sarkissova Suite”. Karina Sarkissova was a solo dancer with the Wiener Staatsoper ballet company and acts as an “ambassador” for the hotel (lending her name and face to the hotel and the Sarkissova Suite). The ballet theme is present throughout the suite – ballet shoes and a ballet barre and mirror are provided to let you try a few dance steps.

GROUND FLOOR

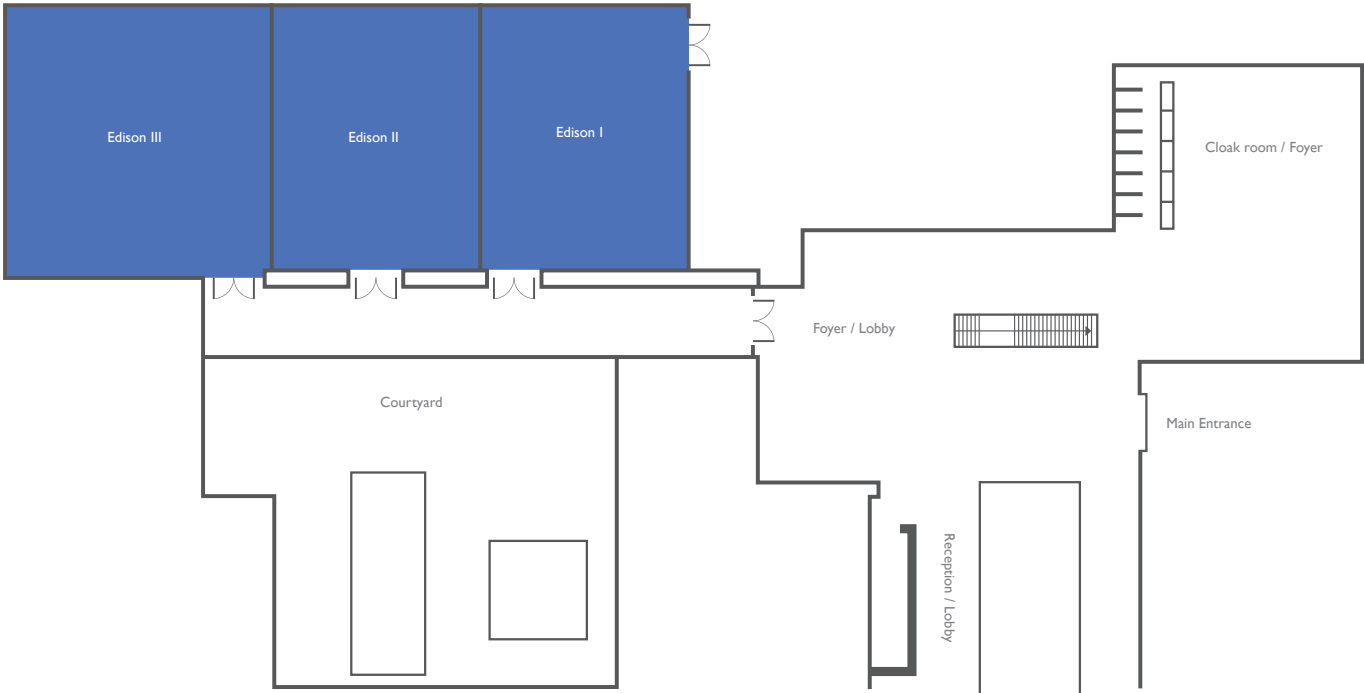

1ST FLOOR

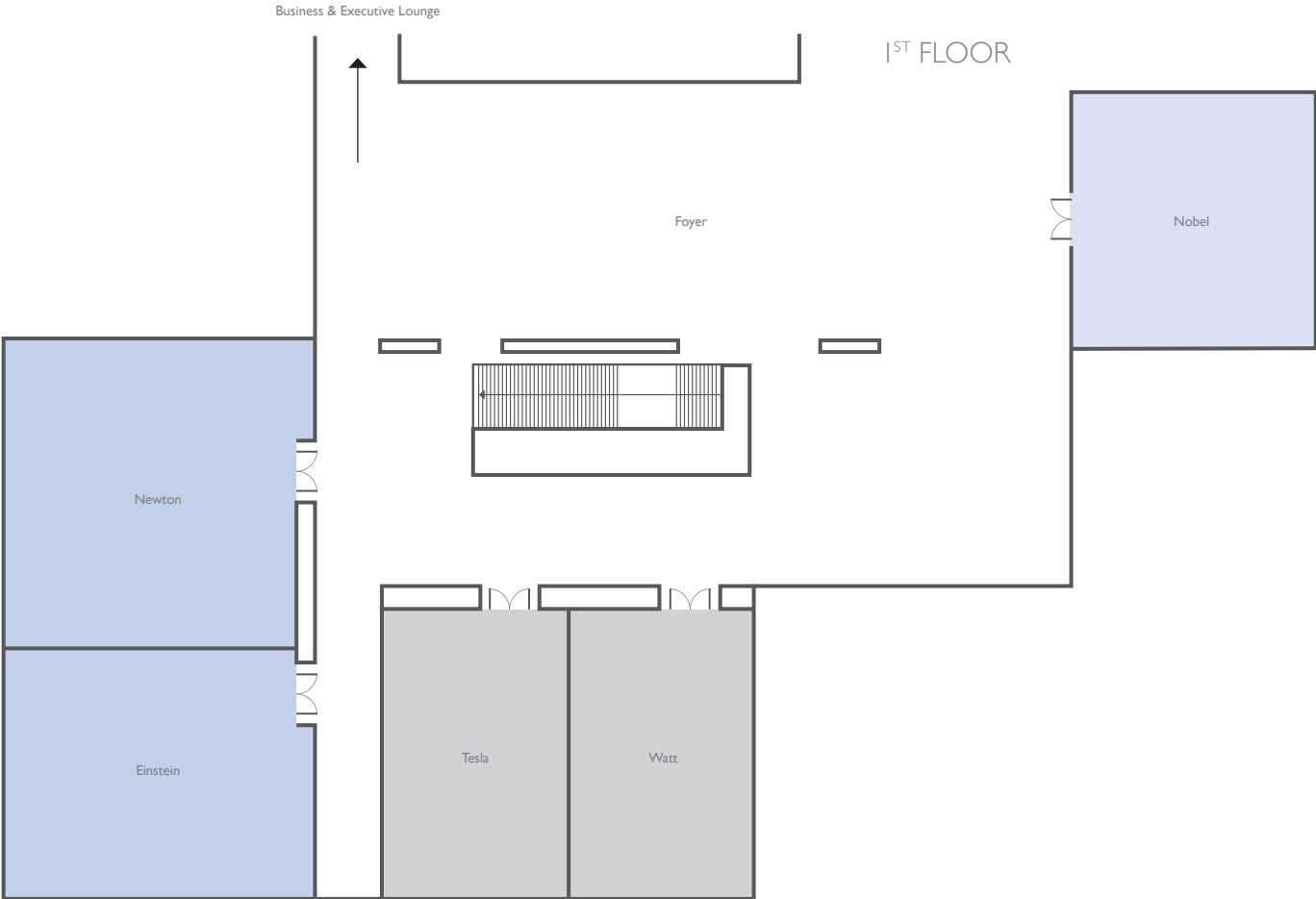

RESTAURANT & BAR

The Radisson Blu Super Breakfast is an extensive buffet featuring the best of Continental, North European, and American cuisine. The culinary delights on offer at the hotel restaurant 'Regio' feature the very best seasonal and locally-sourced ingredients and are served with a choice of Austrian and international wines. **Taking enjoyment to another level.** The hotel restaurant, Regio, is the place to discover Austrian culinary classics with a contemporary twist. Experience our unique take on regional cuisine, an approach that has won us a loyal following – and not just among hotel guests. **The perfect mix.** Savour the perfect end to the day from the terrace of the Chino bar with its impressive views of the hotel park as you enjoy our excellent cocktails and fine spirits.

MEETING ROOM CAPACITY							
MEETING ROOMS	Floor area m ²	Cabaret a 6 pax	U-shape	Boardroom	Classroom	Theater	Cocktail
Edison I	183	48	32	-	80	160	70
Edison II	184	48	32	-	80	160	70
Edison III	238	72	50	-	96	200	100
Edison I + II + III	606	240	-	-	312	500	350
Newton	94	24	24	20	28	60	-
Einstein	78	24	20	20	24	60	-
Newton + Einstein	172	48	40	40	48	100	70
Tesla	53	12	18	18	16	40	-
Watt	53	12	16	18	14	40	-
Tesla + Watt	106	30	30	36	30	80	-
Nobel	63	18	22	20	26	60	-



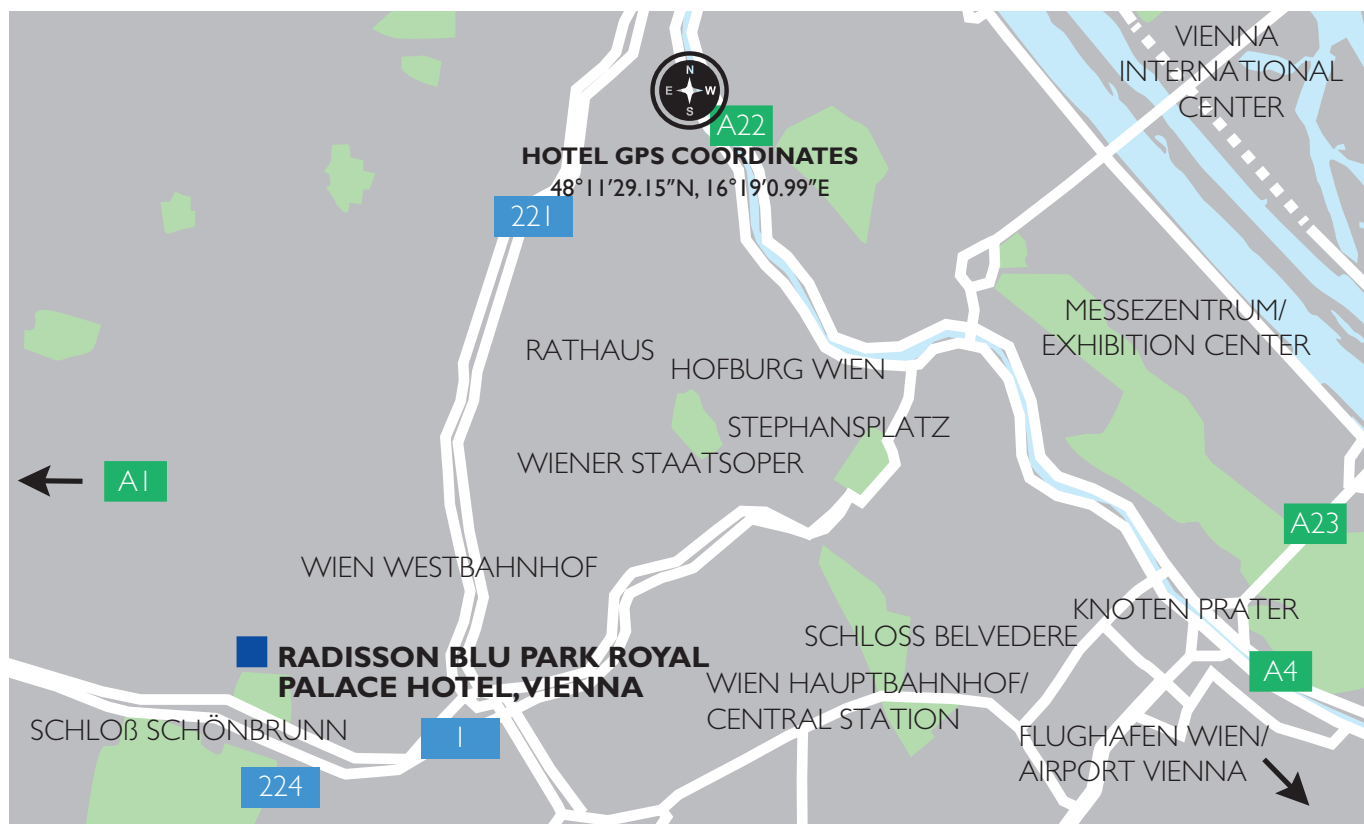

ARRIVAL

By car: Westautobahn (A1) – city center – B1 – at Schönbrunn Palace turn right onto Schloßallee – 300 m to hotel (right hand side). **Südautobahn (A2)** – exit city center/Altmannsdorf – take A23 – B224 Altmannsdorfer Bundesstraße – left to B1/Linke Wienzeile – at Schönbrunn Palace turn right onto Schloßallee – 300m to hotel (right hand side). **Ostautobahn (A4)** – Knoten Prater – A23 direction Altmannsdorf – B224 Altmannsdorfer Bundesstraße – left to B1/Linke Wienzeile – at Schönbrunn Palace turn right onto Schloßallee – 300m to hotel (right hand side) **Donauuferautobahn (A22)** – Exit Nordbrücke direction city center – B227 direction Gürtel – turn left onto Währinger Gürtel –turn right onto Felberstraße –turn right onto Schloßallee – 300m to hotel (right hand side) **Public transport:** Schönbrunn – Underground U4 **Penzinger Straße** – tramlines: 10, 46, 49, 52, 60 **From Westbahnhof** – tramlines 52 or 60 until Penzinger Straße **From Hauptbahnhof** – underground U1 and U4 until Schönbrunn; tramlines 18 and 60 until Penzinger Straße **From Airport Vienna** – city train S7 until Wien Mitte – underground U4 until Hietzing – tramline 10 until Penzinger Straße

Radisson Blu Park Royal Palace Hotel

Operated by Austria Trend Hotels

Schlossallee 8, 1140 Vienna, Austria

T: +43 1 89 11 0 info.parkroyalpalace.vienna@radissonblu.com

radissonblu.com/park-royal-palace-hotel-vienna